



Burgess Road | | Rochester | ME2 4DE

£260,000



Burgess Road |
Rochester | ME2 4DE
£260,000

No Onward Chain! This two/three bedroomed terraced house is ready for immediate occupation. Ideal for a first time buyer or investor, the house is set over three levels with two receptions, two first floor bedrooms one with en-suite toilet and the lower level with bedroom three/reception, modern fitted kitchen, lobby and shower room. There is gas central heating and double glazing. Located in a popular area close to the High Street, schools, Marks and Spencer food hall, Matalan, Tesco, Asda, Next, Argos and other High Street retailers. Strood mainline station is within a quarter mile and there are good road links to A2, M2 and M20. Call to view.

Double glazed ENTRANCE DOOR to
LOUNGE: double glazed window to front, radiator, stairs to first floor

- NO ONWARD CHAIN
- TWO/THREE BEDROOMS
- SHOWER ROOM
- FITTED KITCHEN
- LOUNGE AND DINING ROOM



Energy Efficiency Rating		
	Current	Potential
Very energy efficient - lower running costs		
(92 plus) A		
(81-91) B		
(69-80) C		
(55-68) D		
(39-54) E		
(21-38) F		
(1-20) G		
Not energy efficient - higher running costs		
England & Wales		
		EU Directive 2002/91/EC

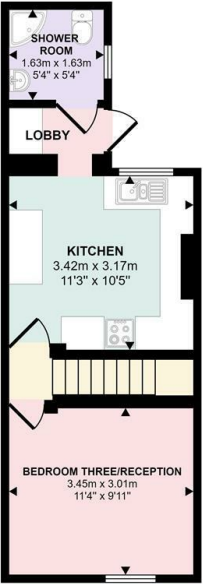

Lower Ground Floor
Approx 29 sq m / 316 sq ft

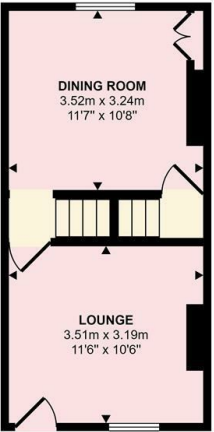

Ground Floor
Approx 26 sq m / 278 sq ft

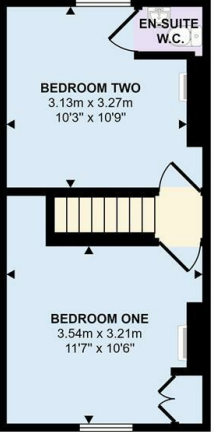

First Floor
Approx 27 sq m / 288 sq ft

This floorplan is only for illustrative purposes and is not to scale. Measurements of rooms, doors, windows, and any items are approximate and no responsibility is taken for any error, omission or mis-statement. Icons of items such as bathroom suites are representations only and may not look like the real items. Made with Made Snappy 360.

2B Crow Lane
Rochester
Kent
ME1 1RF
01634 829080

admin@machin-lane.co.uk
<https://www.machin-lane.co.uk/>